

# ER7-900

**EFORT**

**ER7-900,**  
Maxium payload 7 kg with maxium reach 911 mm.

■ **Highlights**

High protection level IP65 of the robor body help customers easy to face dusty, oil misty, high humidity and other harsh environment;  
Thanks to the high stiffness transmission design and advanced trajectory algorithm, the improved robot accuracy performance helps customers to face variety of application scenarios.

■ **Applications**

It can be used in handling operations, sorting, assembling, painting, etc.

■ **Industries**

Suitable for 3C, food and beverage, metal parts, education, plastic, pharmaceutical and other industries.



**SPECIFICATIONS**

|                                |                               |                                   |
|--------------------------------|-------------------------------|-----------------------------------|
| <b>Model</b>                   | ER7-900                       |                                   |
| <b>Type</b>                    | Articulated                   |                                   |
| <b>Controlled axes</b>         | 6 Axes                        |                                   |
| <b>Max. payload on wrist</b>   | 7 kg                          |                                   |
| <b>Repeatability</b>           | ±0.03 mm                      |                                   |
| <b>Robot weight</b>            | 38 kg                         |                                   |
| <b>Reach</b>                   | 911 mm                        |                                   |
| <b>Robot IP grade</b>          | IP65/IP67 (Wrist)             |                                   |
| <b>Cabinet IP grade</b>        | IP20                          |                                   |
| <b>Drive mode</b>              | AC servo drive                |                                   |
| <b>Installation</b>            | Floor, Upside-down, Wall      |                                   |
| <b>Installation enviroment</b> | <b>Ambient temperature</b>    | 0~45 °C                           |
|                                | <b>Ambient humidity</b>       | RH≤80% (No dew nor frost allowed) |
|                                | <b>Vibration acceleration</b> | 4.9 m/s <sup>2</sup> (<0.5 G)     |

|  |           |                        |
|--|-----------|------------------------|
| <b>Allowable load moment at wrist</b>  | <b>J4</b> | 16 N·m                 |
|  | <b>J5</b> | 16 N·m                 |
|  | <b>J6</b> | 9 N·m                  |
| <b>Allowable load inertia at wrist</b> | <b>J4</b> | 0.45 kg·m <sup>2</sup> |
|  | <b>J5</b> | 0.45 kg·m <sup>2</sup> |
|  | <b>J6</b> | 0.14 kg·m <sup>2</sup> |
| <b>Maximum speed</b>                   | <b>J1</b> | 300°/sec               |
|  | <b>J2</b> | 255°/sec               |
|  | <b>J3</b> | 320°/sec               |
|  | <b>J4</b> | 450°/sec               |
|  | <b>J5</b> | 450°/sec               |
|  | <b>J6</b> | 720°/sec               |
| <b>Motion range</b>                    | <b>J1</b> | ±170°                  |
|  | <b>J2</b> | +100°/-135°            |
|  | <b>J3</b> | +200°/-75°             |
|  | <b>J4</b> | ±190°                  |
|  | <b>J5</b> | ±120°                  |
|  | <b>J6</b> | ±360°                  |

**OPERATING SPACE**

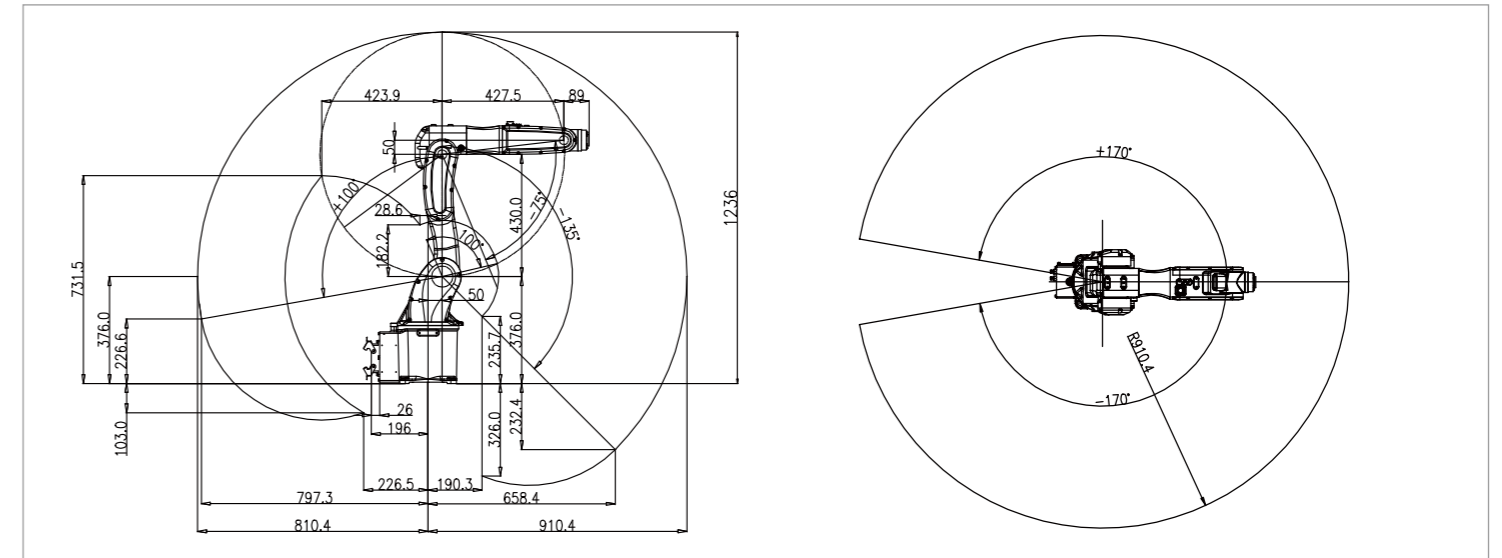

**BASE MOUNTING SIZE**

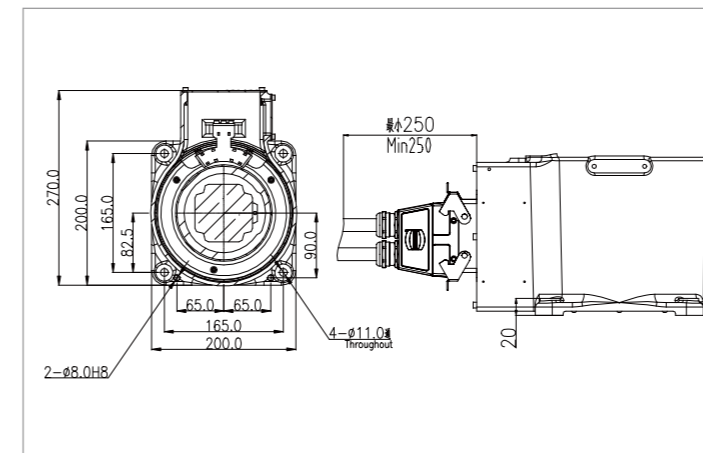

**END FLANGE MOUNTING SIZE**

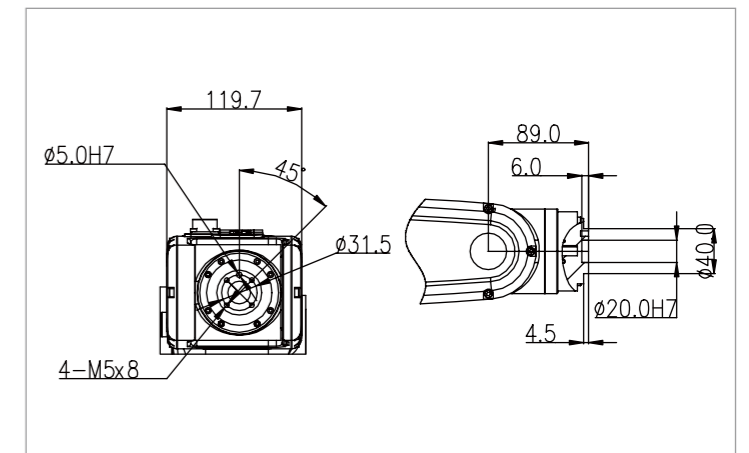

**EFORT INTELLIGENT EQUIPMENT CO.,LTD.**

PHONE: (00 86) 400-052-8877

ADDRESS: No.96 East Wanchun Road, China(Anhui) Pilot

Free Trade Zone Wuhu Area, Wuhu, Anhui Province, China

WWW.EFORT.COM.CN